

## DECK 11



### Dun Aengus Club Class Lounge

Upgrade, for a supplement, to our luxurious Dun Aengus Club Class Lounge, making your journey even more comfortable and enjoyable. Situated on deck 11 it boasts magnificent sea views and offers a host of super benefits!

## DECK 11 & 9

### Outer Decks 11 & 9

The perfect way to begin and end your voyage is from the outer decks 11 and 9 as the ship departs or arrives in port. There is also designated smoking areas.

## DECK 8



### Cyber Zone

And for anyone with the cyber bug, the Cyber Zone is the place to go at warp speed!



### Druid's Delights

Enjoy a tasty snack from Druid's Delights.



### Children's Play Area

Where the younger kids are entertained with films, games or simply amusing themselves.



### The Travel Galleria

Pick up some great deals in fragrances, fashion or electrical goods in "The Travel Galleria"!



### Surf Box

Surf Box Internet access terminal is located on Deck 7.



### Wifi on board

Wifi Internet access available on Deck 7, 8 & 11.

# ISLE OF INISHMORE - DECK PLAN

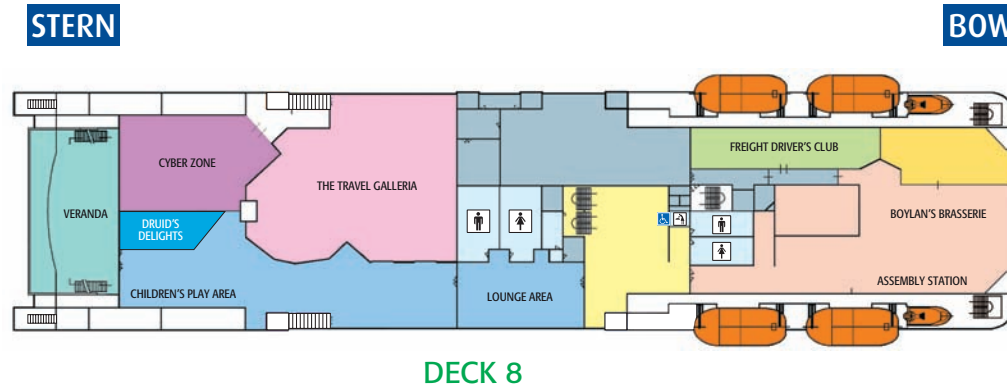

DECK 8

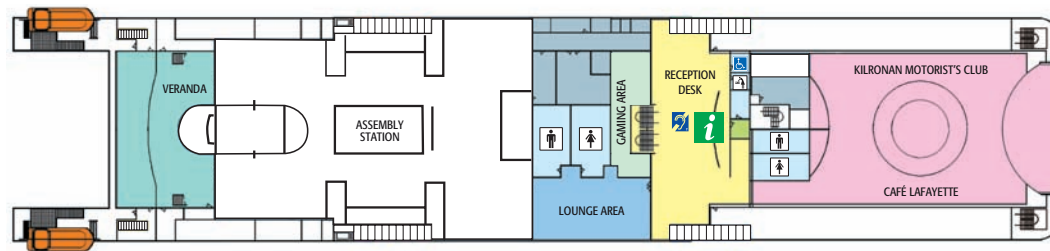

DECK 7

## DECK 8



### Boylan's Brasserie

For a varied menu you can't beat Boylan's Brasserie for choice, value and taste.



### Freight Driver's Club

Lounge and restaurant reserved exclusively for Freight Drivers.

## DECK 7



### Gaming Area

Enjoy a flutter on the latest generation of gaming machines.



### Reception Desk & Bureau de Change

Please let us be of assistance at any time during your voyage. There is also a hearing loop installed at Reception.



### Kilronan Motorist's Club

A comfortable lounge where you can relax and unwind before driving on to your final destination.



### Cafe Lafayette

Offers a range of sandwiches, panini, baps & light refreshments.



### Assembly Stations

Assembly Stations are located on **Deck 7** and **Deck 8**.