

# WELCOME ABOARD



IRISH FERRIES

Sea travel differently

## Important Safety Information

Safety is important, as is the comfort and enjoyment onboard for all our passengers on the **Isle of Inisheer**. We have a number of safety procedures which must be followed at all times. These are in place for your benefit.

### Safety on Board

We operate to the highest safety standards, as set down by the **International Maritime Organisation (IMO)** and are constantly monitored by the regulatory authorities in each country.

### Please observe the following simple safety rules:

- Please listen carefully to all announcements.
- Unaccompanied children (under 18 years old) are not permitted on outside decks.
- Note outside decks may be slippery when wet.
- When moving around the ship, please note the **Assembly Station signs**, and read the safety messages on these signs.
- Familiarise yourself with instructions on how to put on life jackets.

These instructions are posted around the ship.

- Dispose of litter only in the bins provided. Do not litter the sea.
- Remember, we're here to ensure you enjoy your trip with us.

to us at our Reception Desk (Deck 7).

### Vehicle Loading Procedure

Loading vehicles onto **Isle of Inisheer** is a complex procedure. To achieve the best loading arrangements please be aware that a vehicle that has checked in after you may be loaded before you.

### Embarkation

On arrival on the car deck, a crew member will direct you to a parking space. Before leaving your vehicle please ensure you have applied the hand brake and left the car in gear. If you are driving a motorhome or towing a caravan please ensure all portable gas cylinders are safely secured and turned off. Due to safety and security regulations, access to your vehicle at sea is not permitted. Please remember to take any luggage to your vehicle during the crossing, along with any valuables and medication. Lock your vehicle. Ensure your car alarm motion sensor is switched off.

Animals are not permitted in the passenger coloured area with the exception of approved Assistance Dogs wearing a regulation coloured harness or jacket.

### Check Your Stairways & Elevators

To help you locate your vehicle at disembarkation time, please remember the Car Deck number and the colour stairs / lift used as you leave your car. Please do not proceed to your vehicle until told to do so. Your co-operation is very much appreciated and will assist in a smoother disembarkation for all.

### Disembarkation

Please do not proceed to your vehicle until disembarkation announcements have been made. Please make yourselves comfortable and await instructions. Do not start your vehicle's engine or move your vehicle until instructed to do so and please follow all directions given by ship's crew. Please take your personal belongings with you when disembarking the ship.

### Access and Facilities

If you or a member of your party has reduced mobility or has any special requirements, please bring this to the attention of our crew at the Reception Desk on Deck 7, who will be happy to assist you. On board **Isle of Inisheer** there are designated wheelchair accessible areas including toilets (Decks 7&8) and a lift (blue lift from the car decks to Decks 7&8). A hearing loop is also installed at our Reception Desk (Deck 7).

### NO SMOKING



IT IS ILLEGAL TO SMOKE IN ANY ENCLOSED AREA ON THIS SHIP.

Smoking (including electronic cigarettes) is only permitted in the designated smoking areas on the outer decks. Please take care when disposing of cigarettes. Use the bins provided. Don't litter the sea.

IRISH FERRIES



# WELCOME FÁILTE BIENVENUE ISLE OF INISHEER

## A Sea of Information

Irish Ferries has a long and proud heritage of carrying passengers in comfort across the seas, connecting Ireland to Britain, Britain to France and Ireland to France. The **Isle of Inisheer** crosses from Ireland to France providing a regular back to back service, with **W.B. Yeats**.

Irish Ferries also has a tradition of extending a warm welcome and delivering a real sense of Irish hospitality to all our passengers. Another tradition we have, is that is of naming our ships after some of the greats of Irish literature, such as Yeats, Joyce and Swift, and of some of the most beautiful islands from around our coastline. Inisheer is one of the smallest and most beautiful of these islands, one of the three Aran Islands, just off the coast of Galway and sharing a topography similar to the world famous Burren National Park.

<b>Shipyard:</b>	IZAR ASTILLERO SEVILLA, Spain
<b>Date of build:</b>	2000
<b>Overall Length:</b>	180m
<b>Gross tonnage:</b>	25,152 tonnes
<b>Max Service Speed:</b>	22.5kn
<b>Vehicle Decks Size:</b>	1,950 lane meters
<b>Engines:</b>	4 x Wärtsilä 9L38, at 5,940 kw each.
<b>Bow Thrusters:</b>	2 x 1300kw Brunvoll Thrusters
<b>Anchors:</b>	2 x Stockless anchors at 5,850kgs each

## Deck Plan

Stern

Deck 8

Bow

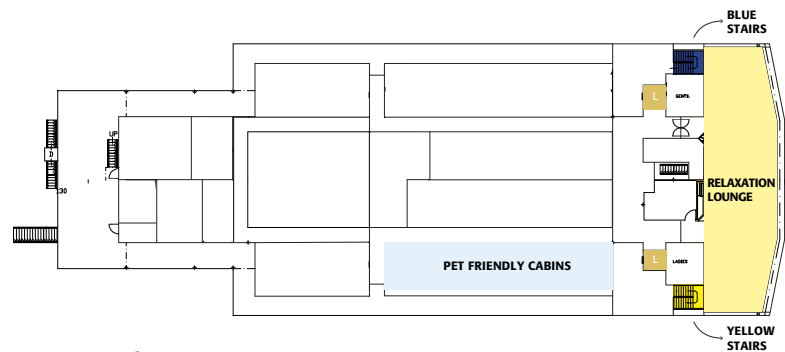

Deck 7

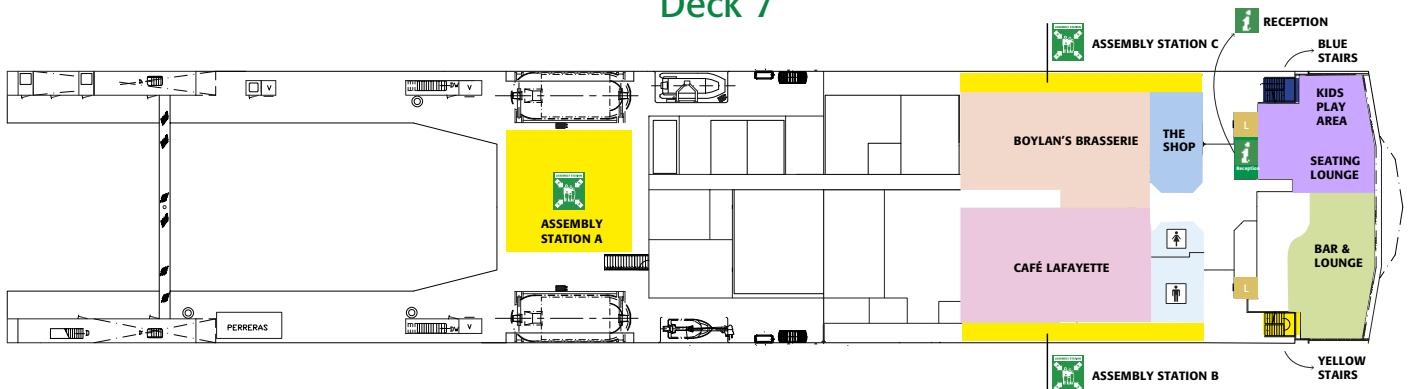

## Isle of Inisheer – The On Board Experience

### Boylan's Brasserie Deck 7



Taste our traditional menu offering a wide range of hot and cold freshly made food.

### Café Lafayette Deck 7



Serving freshly made sandwiches, pastries, hot and cold beverages.



### The Shop Deck 7

Make use of your **tax free allowances** and check out great discount deals on gifts, fragrances and alcohol.



### Reception Deck 7

We are here to help at any time during your sailing.

### Outer Decks 7 & 8 Deck 7&8

The perfect way to begin and end your voyage is from the outer Decks 7 and 8 as the ship departs or arrives in port. These are also designated smoking areas.



### Kids Play Area Deck 7

There is a small play area suitable for the younger members of your party, in the forward lounge, on Deck 7.

### Pet Friendly Cabins Deck 8



It is possible to travel with your pet in one of our specially adapted pet friendly cabins on Deck 8. Sit back and relax with your favourite travel companion by your side. Talk to the team at Reception to book a pet friendly cabin.



# TAX FREE

**CHOOSE YOUR GIFTS AT**  
[irishferries.com/shopping](http://irishferries.com/shopping)  
**AND COLLECT YOUR ORDER ONBOARD!**